

This drawing should not be scaled. Dimensions to be verified on site. Any discrepancies should be referred to the Engineer prior to work being put in hand. This drawing is the property of Waterman Moylan Consulting Engineers Limited and is issued on the condition that it is not copied, reproduced, retained or disclosed to any unauthorized person, either wholly or in part without the consent in writing of Waterman Moylan Consulting Engineers Limited. Block S, East Point Business Park, Dublin D03 H3F4 Ireland. T: +353 1 664 8900

- NOTES:
- DO NOT SCALE. USE FIGURED DIMENSIONS ONLY.
 - THIS DRAWING IS TO BE READ IN CONJUNCTION WITH ALL OTHER RELEVANT ARCHITECTURAL AND ENGINEERING DRAWINGS.

LEGEND

- EXTENT OF WORKS
- EXTENT OF OWNERSHIP
- x 00.000 PROPOSED ROAD LEVEL
- | XXX PROPOSED CHAINAGE
- / XXX PROPOSED ROAD GRADIENT
- FFL** 109.7 PROPOSED FINISHED FLOOR LEVEL

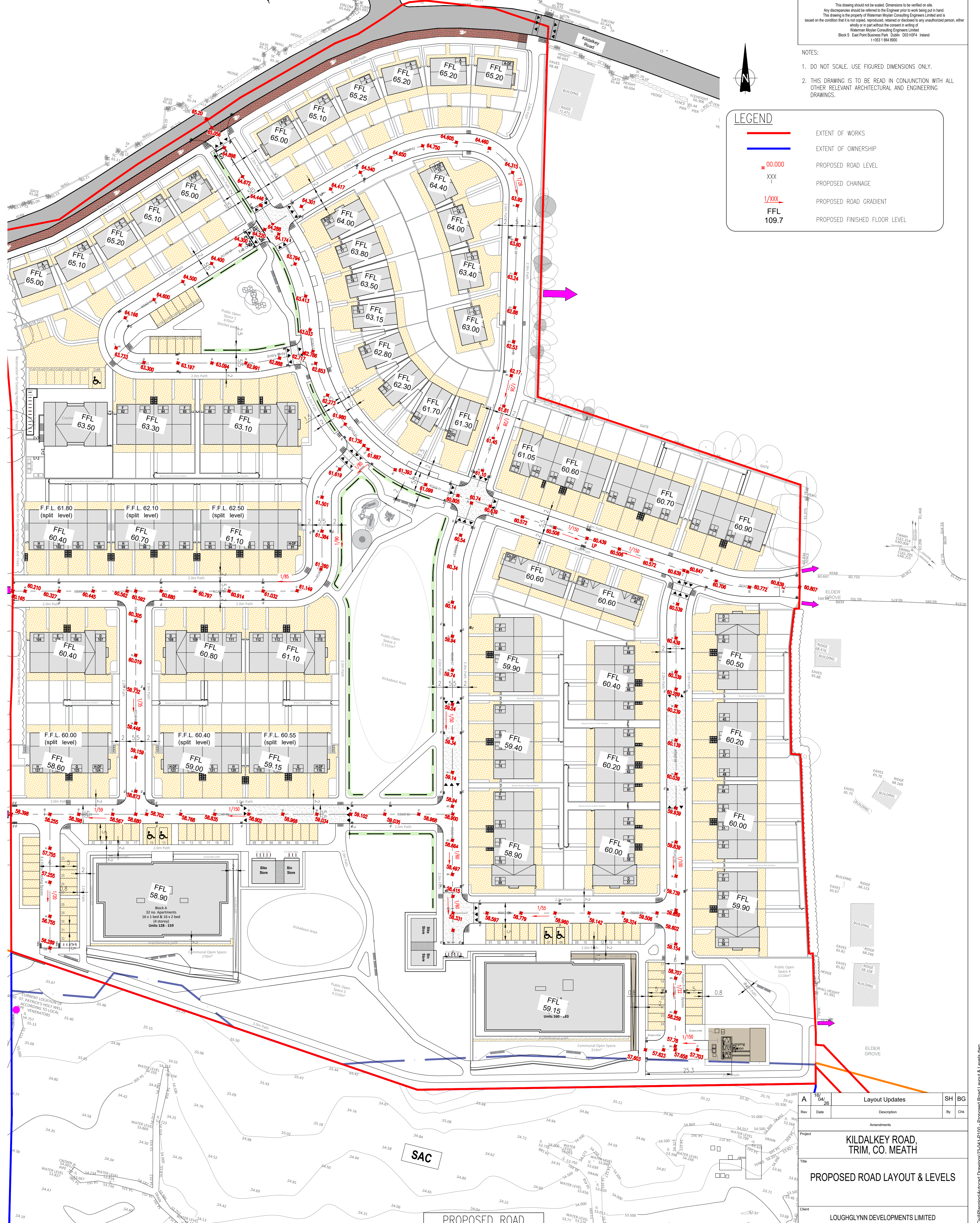

PROPOSED ROAD LAYOUT & LEVELS
SCALE 1:500 @A1

Ordnance Survey Ireland
Ordnance Survey Ireland Licence No. EN 0006025 © Ordnance Survey Ireland/Government of Ireland.

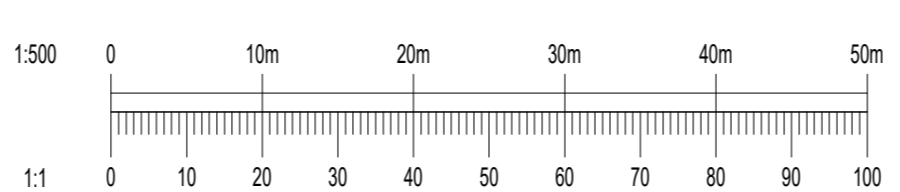

Rev	Date	Description	By	Chk
A	16/04/26	Layout Updates	SH	BG

Amendments

Project
KILDALKEY ROAD, TRIM, CO. MEATH

Title
PROPOSED ROAD LAYOUT & LEVELS

Client
LOUGHLINN DEVELOPMENTS LIMITED

waterman moylan

BLOCK S, EASTPOINT BUSINESS PARK, ALFIE BYRNE ROAD, DUBLIN D03 H3F4 IRELAND. Tel: (01) 664 8900. Email: info@waterman-moylan.ie www.waterman-moylan.ie

FOR PLANNING ONLY

Designed By	SK	Approved	BG	Waterman Ref	23-041
Drawn By	SH	Date	NOV. 2025	Scales @ A1	1:500 @A1
Project	Originator	Volume	Level	Type	Role
TRIM - WAT - ZZ - XX - DR - C - P100					A

Drawing Location: N:\Projects\23-041 Trim Co. Meath\Drawings\Waterman Moylan\Civil\Planning\Autocad\Drawings\23-041-P100 - Proposed Road Layout & Levels.dwg Date: Jun 18, 2025 - 2:40pm